

TOWN HWY. No.	CLASS 3	CLASS 4	LENGTH IN MILES
2	0.12		
3	0.15	(0.50)	
4		(0.40)	
5		(0.60)	
6		(1.03)	
7		(1.42)	
8	0.05		
9	0.18		
10		(0.36)	
11		(0.08)	
12		(0.37)	
13	0.03		
14	0.05		
<b>TOTAL</b>	<b>0.58</b>	<b>4.76</b>	

TOWN HWY. No.	LENGTH IN MILES "NOT UP TO STANDARD"
10	(0.04)
13	(0.07)
<b>TOTAL</b>	<b>0.11</b>

\* The sections of the town highways listed above are legally Class 3, but have been deemed "Not Up To Standard" and are functionally Class 4 Town Highways

MILEAGE SUMMARY		
CLASS 2		
TH-1	0.400	
<b>TOTAL CLASS 2</b>	<b>0.400</b>	
CLASS 3		
<b>TOTAL CLASS 3</b>	<b>0.58</b>	
<b>TOTAL TOWN</b>	<b>0.980</b>	
STATE HIGHWAY		
VT-114	9.982	
VT-147	0.178	
NSH-NSH	0.573	
<b>TOTAL STATE HIGHWAY</b>	<b>10.733</b>	
<b>TOTAL STATE</b>	<b>10.733</b>	

**TOTAL, TRAVELED HIGHWAYS, FEB. 10, 2013: 11.713**  
(Excludes Class 4, Legal Trail, and Unidentified Corridor Mileage)

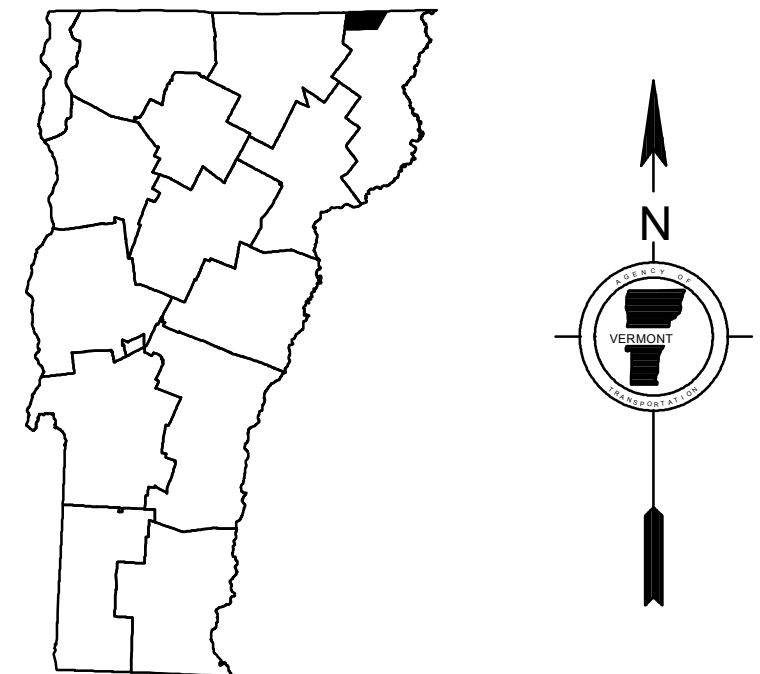
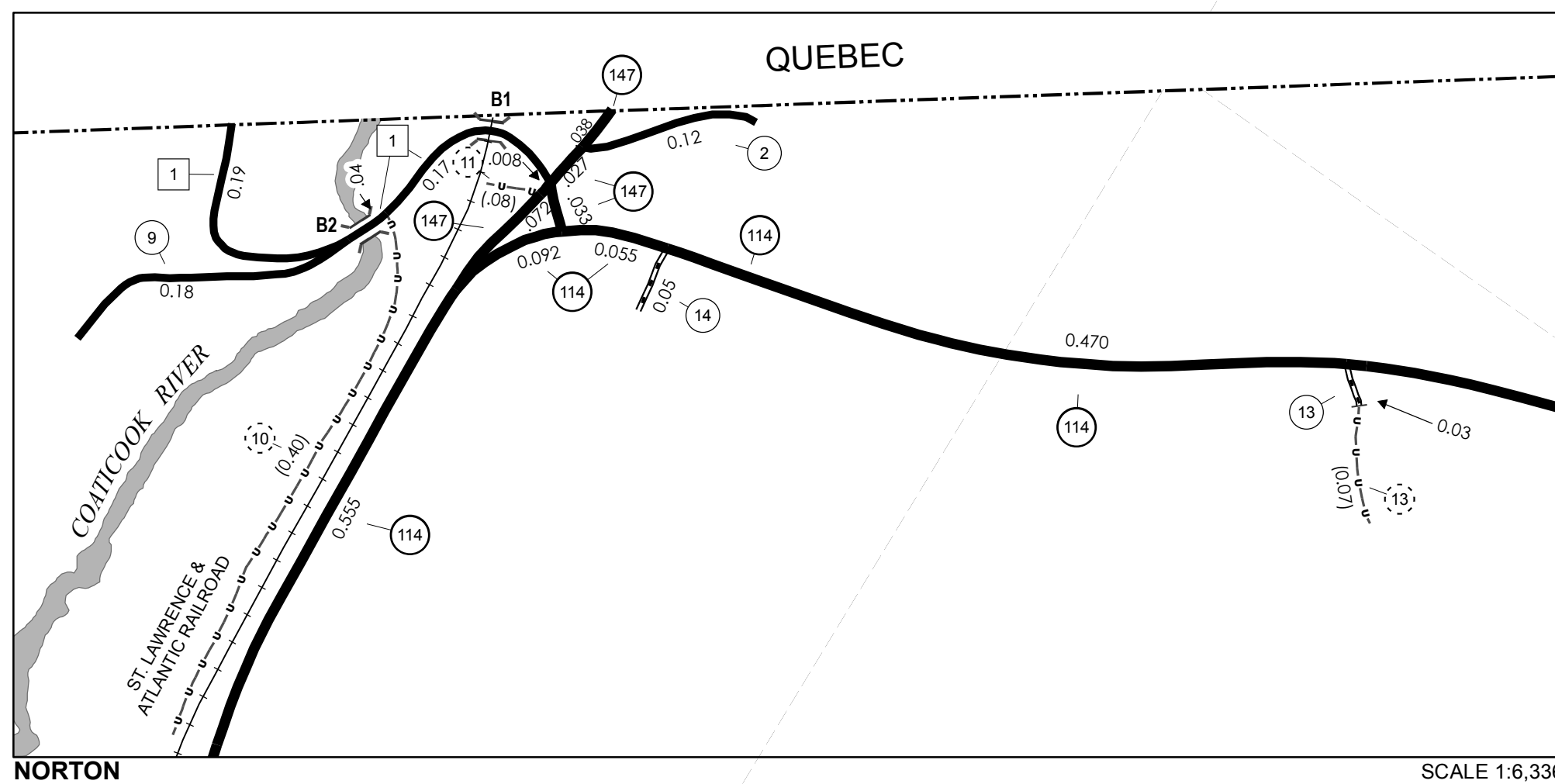
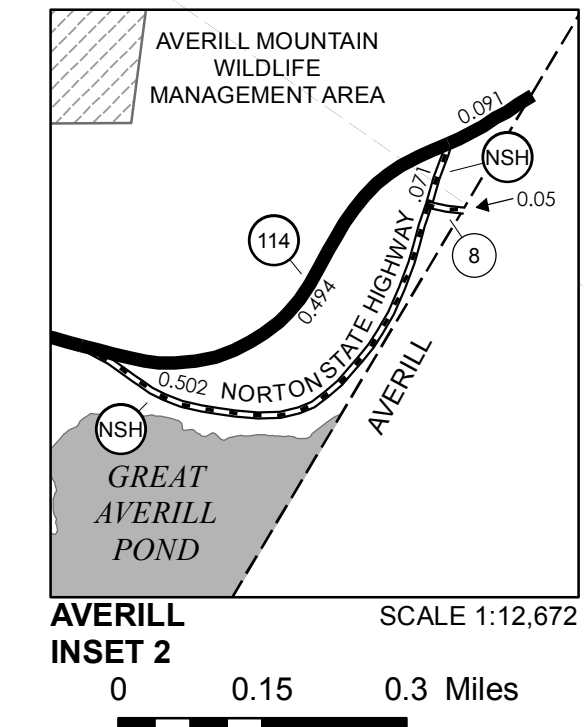

# VERMONT GENERAL HIGHWAY MAP Town of Norton

ESSEX COUNTY

Transportation District #9

Prepared by the  
Vermont Agency of Transportation  
Division of Policy, Planning and Intermodal Development  
in cooperation with  
U.S. Department of Transportation  
Federal Highway Administration

Mileage as of February 10, 2013  
Map prepared October 03, 2013

SCALE 1:31,680

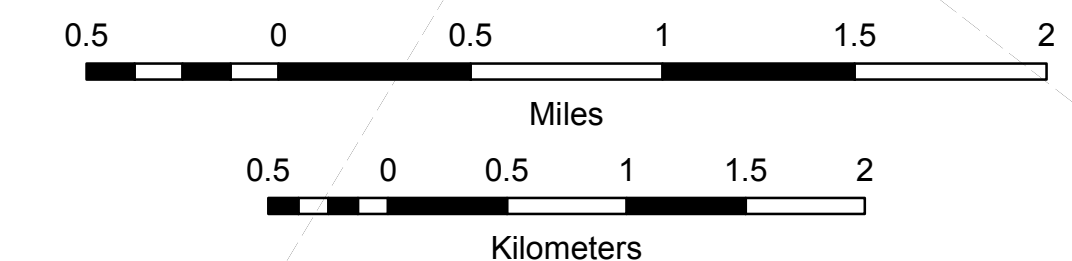

- HIGHWAYS**
  - INTERSTATE
  - U.S. ROUTE
  - STATE ROUTE
  - CLASS 1
  - CLASS 2
  - CLASS 3
  - CLASS 4
  - LEGAL TRAIL
  - INTERSTATE OR DIVIDED HIGHWAY
  - STATE - HARD SURFACE OR PAVED
  - TOWN - HARD SURFACE OR PAVED
  - GRAVEL
  - SOIL OR GRADED AND DRAINED EARTH
  - UNIMPROVED OR PRIMITIVE
  - IMPASSABLE OR UNTRAVELED
  - LEGAL TRAIL
  - DISCONTINUED
  - HIGHWAY CLASS CHANGE
  - RAILROAD
  - INACTIVE RAILROAD
  - NFR NATIONAL FOREST ROAD
  - SFH STATE FOREST HIGHWAY
  - PARK AND RIDE
- POLITICAL SUBDIVISIONS**
  - STATE BOUNDARY
  - COUNTY BOUNDARY
  - TOWN BOUNDARY
  - VILLAGE BOUNDARY
  - URBAN COMPACT BOUNDARY
  - WATER BODY
  - STREAM OR BROOK
  - BRIDGE OR CULVERT
  - BRIDGE OR CULVERT GREATER THAN 20'
  - BRIDGE OR CULVERT 6' - 20'
  - STATE BRIDGE OR CULVERT IDENTIFIER
  - TOWN BRIDGE OR CULVERT IDENTIFIER
- FEDERAL CLASSIFICATION IDENTIFIER**
  - FAU URBAN ARTERIAL OR COLLECTOR
  - MA MINOR ARTERIAL
  - MJC MAJOR COLLECTOR
  - MNC MINOR COLLECTOR
  - PA PRINCIPAL ARTERIAL

**DISCLAIMER:**  
The untraveled highways (laid-out town highways), discontinued highways, and legal trails hereon are those of which the Agency of Transportation has record; others may exist.  
Highway and bridge data by the Agency of Transportation. All other data from the Vermont Center for Geographic Information. Only named streams are shown.

Vermont State Plane Coordinate System  
North American Datum of 1983  
SPCS\_Zone\_Identifier: 4400  
Geodetic Reference System 80  
4,000-meter grid, Easting - Northing